



FLOW DIVIDER & COMBINER

27051-216

27061-220

SPOOL TYPE

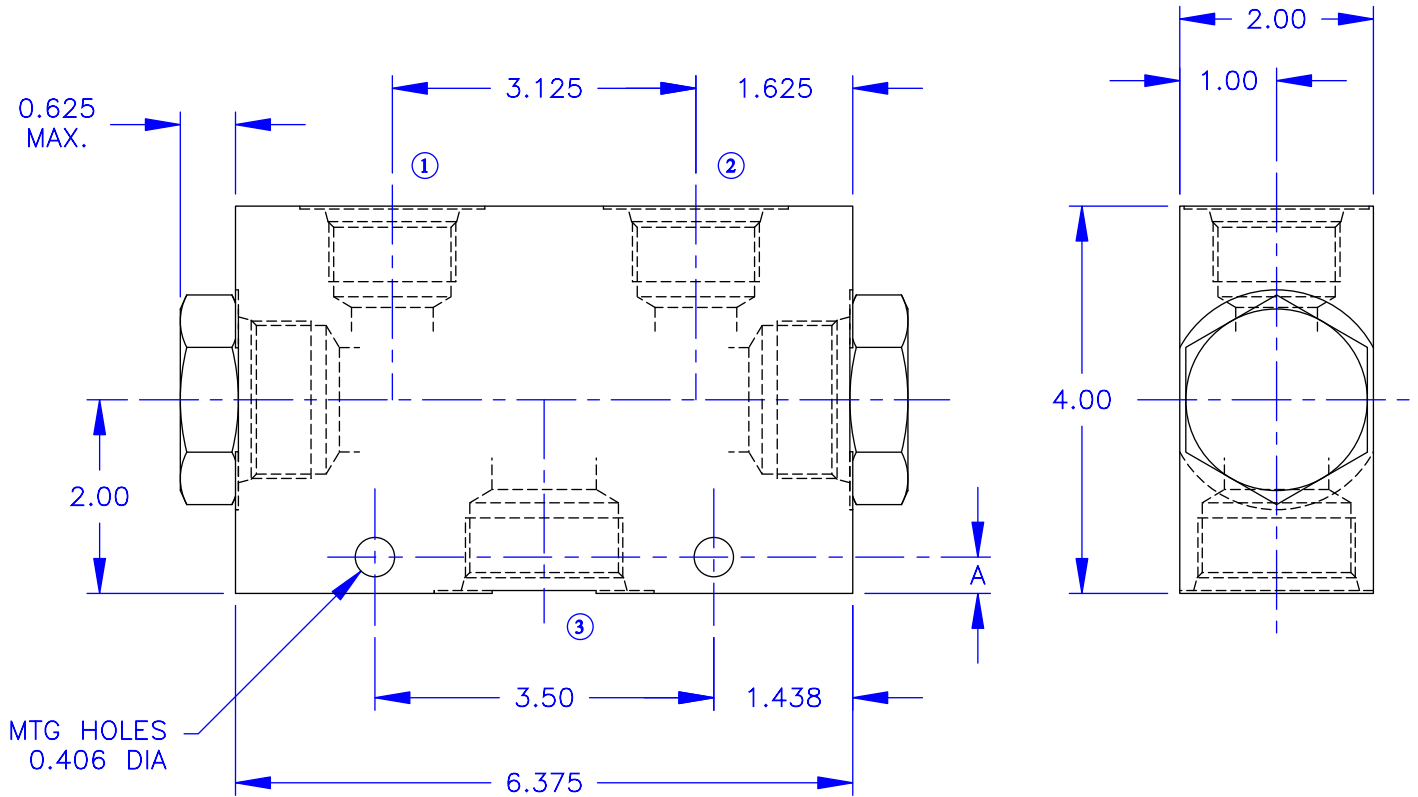

— SPECIFICATIONS —

HYDRAULIC SYMBOL	
RATIO	50/50
MAX. PRESSURE	100 PSI
PRESSURE RANGE	250 PSI TO 4500 PSI
TEMPERATURE RANGE	250°F TO -40°F
FLOW TOLERANCE	±10%
ALL DIMENSIONS IN INCHES	

DESCRIPTION

— A SPOOL TYPE FLOW DIVIDER & COMBINER

OPERATION

- PRESSURE COMPENSATED.
- INPUT FLOW TO PORT #3 IS DIVIDED WITH A 50/50 RATIO BETWEEN PORTS #1 AND #2.
- INPUT FLOW TO PORTS #1 AND #2 WILL BE COMBINED AT PORT #3.

FEATURES

- ALUMINUM BODY, STEEL INTERNALS.
- HYDRAULIC FLUIDS — GENERAL.
- O-RINGS — BUNA-N 90 DURO.
- TAMPER RESISTANT.
- ALTERNATE DIVIDE RATIOS AVAILABLE.

MODEL	PORTS #1&2	PORT #3	FLOW RANGE	A
27051-216	#12 SAE	#16 SAE	25 - 50 GPM	0.875
27061-220	#16 SAE	#20 SAE	30 - 60 GPM	0.375



Vonberg Valve, inc.
HYDRAULIC VALVE SPECIALISTS

3800 INDUSTRIAL AVE.
ROLLING MEADOWS, IL 60008-1085
PH: (847) 259-3800 FAX: (847) 259-3997